

Project's objectives

Computer based directive antenna design dedicated to short waves long distance contacts

Permits to better ensure amateur radio links from ESIEE station to the American continent by ionospheric propagation path

Use the amateur radio band 14 MHz to 14.350 MHz
Approximate wavelength $\lambda = 300 / F = 21.5 \text{ m}$



Yagi antenna 4NEC2

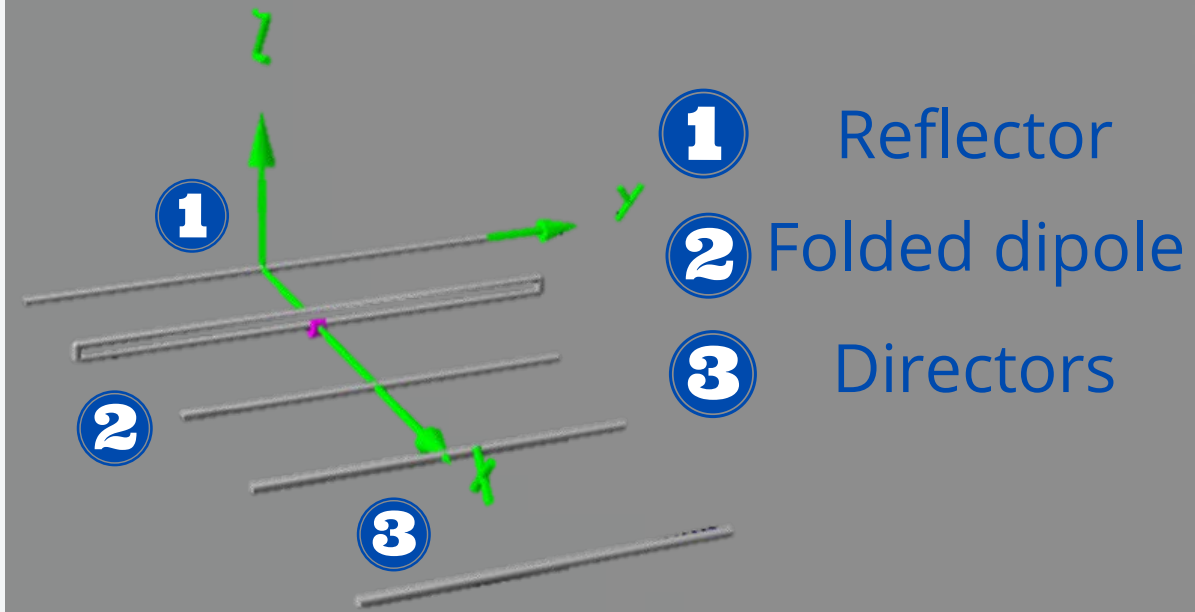

Antenna directivity

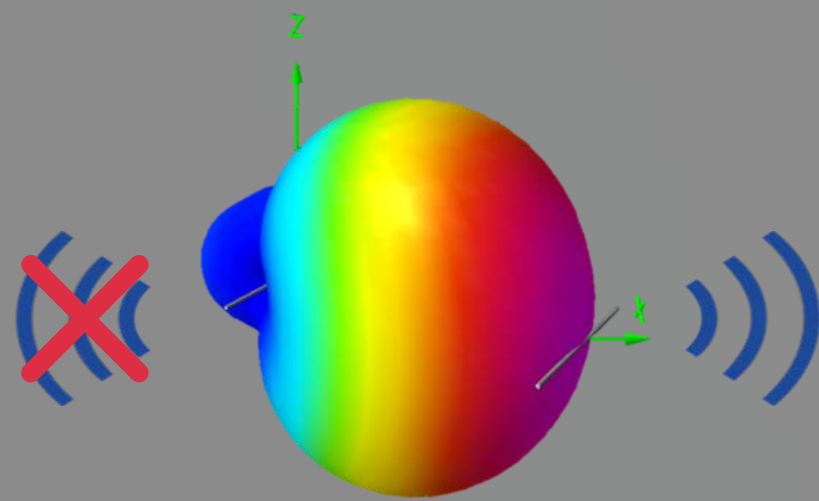

ESIEE 3D modeling

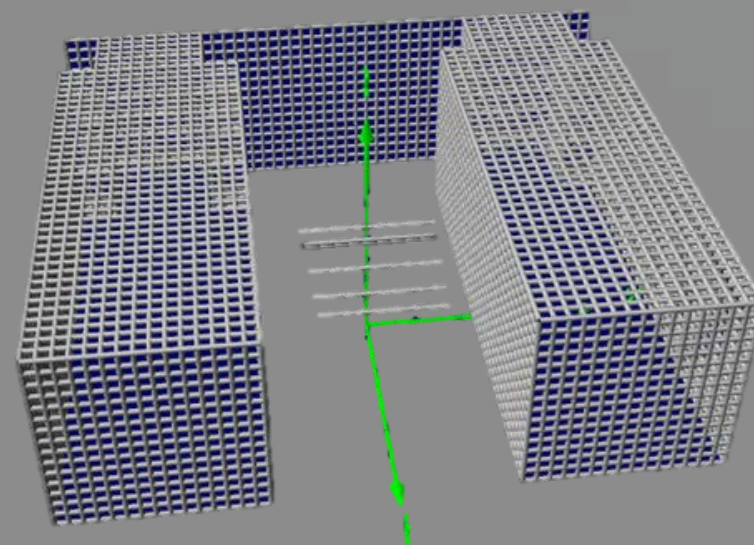

Antenna gain

